

Sq. No. 495  
SEVENTH DISTRICT

FORSHEY ST. SIDE

DUBLIN ST. SIDE

S. CARROLLTON AVE.

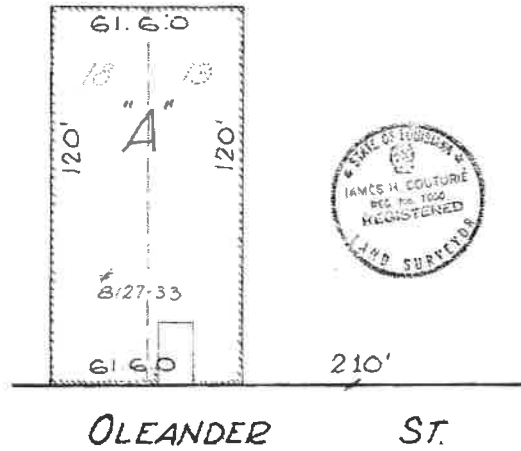

New Orleans, La.  
Aug. 17, 1978

Survey certified correct. Made at the request  
of Jagdish Chawla  
Gilbert, Kelly & Couturie, Inc., Surveying & Engineering

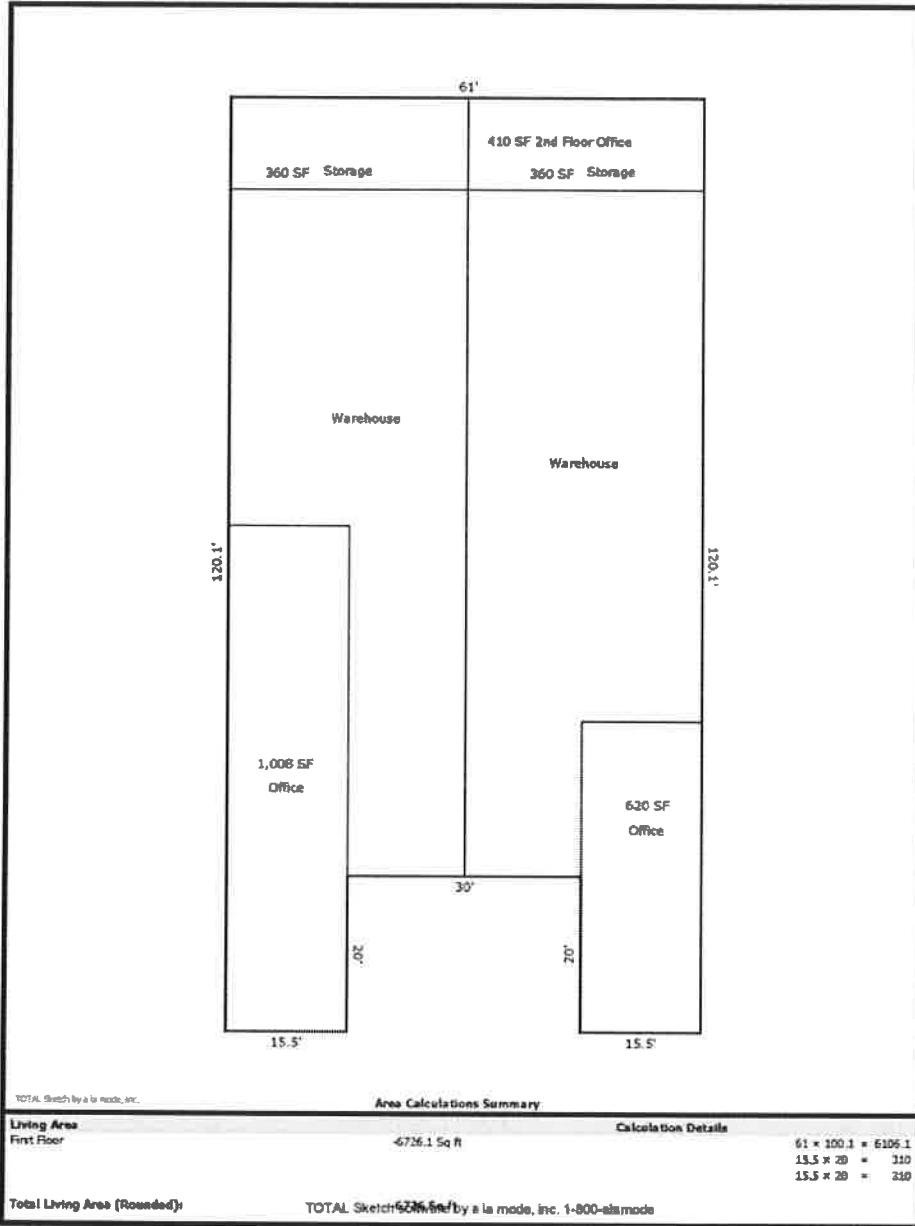

TOTAL Sketch by a la mode, inc.

**Area Calculations Summary**

Living Area	First Floor	Calculation Details
	4726.1 Sq Ft	$61 \times 100.1 = 6106.1$ $15.5 \times 20 = 310$ $15.5 \times 20 = 310$
<b>Total Living Area (Rounded):</b>	<b>5206.1</b>	

TOTAL Sketch by a la mode, inc. 1-800-alamode